

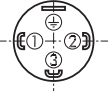
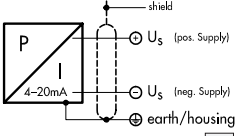

Elektrischer Anschluss / Raccordement électrique / Electrical connection

Schutzart/ protection ²⁾		IP65 ²⁾	
Ausführung Exécution Execution		EN175301-803A (DIN43650-A)	
Ausgangssignal Signal de sortie Output		05 	
 8472.XX.XXXX.XX.19		(Standard)	92
		2	1
		1	2
			

²⁾ nur mit vorschriftsmässig montierter Kabeldose gültig
valable seulement avec fiche femelle montée selon instructions
provided female connector is mounted according to instructions

Anziehdrehmoment Druckanschluss / Couple de serrage raccord de pression / Torque moment pressure connection

15...20Nm

Betriebstemperatur / Température de service / Operating temperature

-25°C ... +85°C

Lagertemperatur / Température de stockage / Storage temperature

-25°C ... +85°C

Medientemperatur / Température du fluide / Media temperature

-25°C ... +85°C

O-Ring (medienberührend) / Joint torique (contact. de médias) / O-Ring (media contacting)

FKM	Code ...XX.61
CR	...XX.62
EPDM	...XX.63



Betriebsdruck / Pression de fonctionnement / Operating pressure

Bereich	0 ... 1.0	Überdruck	max.	4
Plage	0 ... 1.6	Surpression		4
Range	0 ... 2.5	Over pressure		6
	0 ... 4.0			10
[bar]	0 ... 6.0	[bar]		15
	0 ... 10.0			25
	0 ... 16.0			40
	0 ... 25.0			60
	0 ... 40.0			80

Massbilder/ Cotes d'encombrement / Dimensions

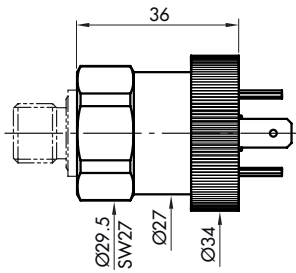

8472.XX.XXXX.05.XX.XX

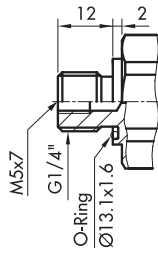

8472.XX.XX17.XX.XX.XX

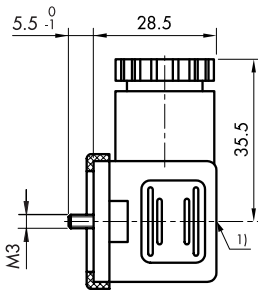

1) Torque moment 50...60 Ncm

8472.XX.XXXX.XX.XX.58