

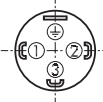





Elektrischer Anschluss / Raccordement électrique / Electrical connection

Schutzart / Protection ¹⁾	IP65 ¹⁾	IP68 ¹⁾	IP69K ¹⁾
Tauchtiefe Profondeur d'immersion Immersion depth	-	1.5m	-
Ausführung Exécution Execution	DIN 43650-A 04 	Cable 08 Abschirmung écran / shield 	DIN 72585 Code 1 25 
Ausgangssignal Signal de sortie Output			
 844X.XX.XXXX.XX.79	844X 2 1 	848X 1 2 	brown black yellow/green blue: not conn.
 844X.XX.2XXX.XX.73	1 2 3 		brown blue black yellow/green

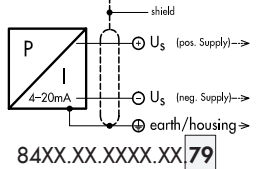
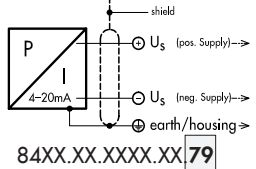
¹⁾ nur mit vorschriftsmässig montierter Kabeldose gültig
valable seulement avec fiche femelle montée selon instructions
provided with female connector is mounted according to instructions

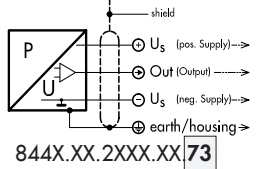
Output 4 ... 20 mA	Load resistance (U _{Supply} - 9V) / 20mA	I _{SUPPLY} ≤ 10 mA	U _{SUPPLY} 9...32 VDC	79
0.5 ... 4.5 V DC ratiométrisch ratiométrique ratiometric	≥ 5.0 kΩ		5 VDC (± 0.25 V)	73

Anziehdrehmoment Druckanschluss/ Couple de serrage raccord de pression / Torque moment pressure connection

max. 25Nm

Betriebstemperatur / Température de service / Operating temperature

SPT: -25°C...+85°C

EPT: -25°C...+100°C (4...20mA) / -25...125°C (ratiometric)

Medientemperatur / Température du fluide / media temperature

SPT: -25°C...+85°C

EPT: max. +85°C (Wasser/ d'eau/ water) / -25...125°C (Kraftstoff, Öl/ carburant, huile/ fuel, oil)

Lagertemperatur / Température de stockage / Storage temperature

SPT: -25°C ... +100°C

EPT: -25°C ... +125°C

O-Ring (medienberührend) / Joint torique (contact. de médias) / O-Ring (media contacting)

SPT & EPT: FKM 70°Sh

Abgleichtemperatur / Température de calibration / Calibration Temperature

SPT: 25°C / EPT: 60°C



Bereich	0 ... 1.0	Überdruck	max.	4
Plage	0 ... 1.6	Surpression		4
Range	0 ... 2.5	Over pressure		6
	0 ... 4.0			10
[bar]	0 ... 6.0	[bar]		15
	0 ... 10.0			25
	0 ... 16.0			40
	0 ... 25.0			60
	0 ... 40.0			80
	0 ... 60.0			120
	0 ... 100.0			200
	0 ... 160.0			320
	0 ... 250.0			500

Massbilder / Cotes d'encombrement / Dimensions

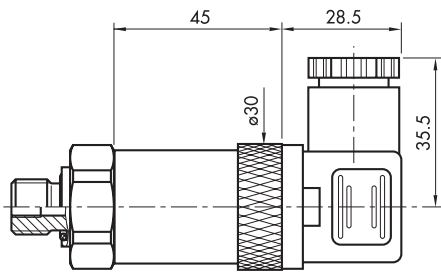

84XX.XX.XXXX.04.XX.XX

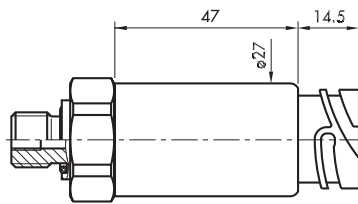

84XX.XX.XXXX.25.XX.XX

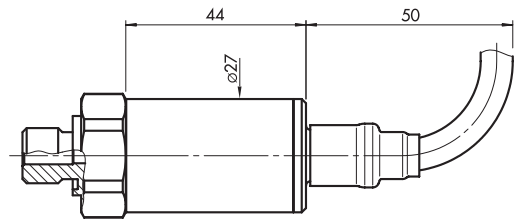

84XX.XX.XXXX.08.XX.XX

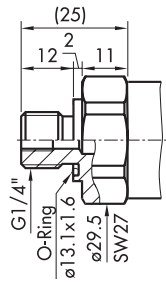

XXXX.XX.XX17.XX.XX

Anschluss von / Connectique de / Connection of

single arrangement

multiple arrangement

I-OUT 2-wires

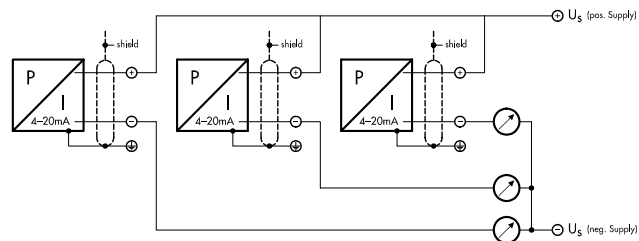
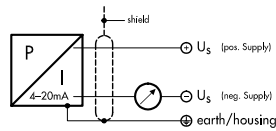

U-OUT 3-wires

