



ANWENDUNG

- ◆ Schiffbau  GL, KRS
- ◇ Motorenbau
- ◇ Schienenfahrzeuge
- ◆ Maschinenbau
- ◆ Hydraulik
- ◆ HLK
- ◇ Kältetechnik
- ◆ Prozess Techn.
- ◆ Wasseraufbereitung
- ◇ Autoindustrie
- ◇ Prüfstände
- ◇ Ex
- ◆ Lebensmittelindustrie
- ◇ Autoklaven

APPLICATIONS

- ◆ Construction navale  GL, KRS
- ◇ Constr. de moteurs
- ◇ Véhicules sur rail
- ◆ Machines-outils
- ◆ Hydraulique
- ◆ CVC
- ◇ Réfrigération
- ◆ Techn. de procédés
- ◆ Traitement de l'eau
- ◇ Industrie automobile
- ◇ Banc d'essai à frein
- ◇ Ex
- ◆ Industrie alimentaire
- ◇ Autoclavage

APPLICATIONS

- ◆ Shipbuilding  GL, KRS
- ◇ Engine manufacturing
- ◇ Railways
- ◆ Machine tools
- ◆ Hydraulics
- ◆ HVAC
- ◇ Refrigeration
- ◆ Process technology
- ◆ Water treatment
- ◇ Automotive industry
- ◇ Test benches
- ◇ Ex
- ◆ Food Industry
- ◇ Autoclaves



HAUPTMERKMALE

- ◆ Sensor: Piezoresistiv
- ◆ Messbereich: 0...0.1 bis 0...1000 bar
- ◆ Ausgangssignal: 4...20 mA
- 4...20 mA mit Blitzschutz
- 0...10 VDC
- ◆ NLH (BSL durch 0): ± 0.1 % d.S. typ.
- ± 0.25 % d.S. typ.
- ± 0.5 % d.S. typ.

VORTEILE

- ◆ Kleine Druckbereiche (bis 100 mbar)
- ◆ Medientemperaturen bis 150°C
- ◆ EMV-Schutz, IEC 61000
- ◆ Optionaler Blitzschutz (IEC 61000-4-5); 10kA (8/20 µs)

CARACTÈRES DISTINCTIFS

- ◆ Capteur: Piézorésistif
- ◆ Plage de mesure: 0...0.1 à 0...1000 bar
- ◆ Signal de sortie: 4...20 mA
- 4...20 mA avec protection
- de parafoudre
- 0...10 VDC
- ◆ NLH (BSL par 0): ± 0.1 % E.M. typ.
- ± 0.25 % E.M. typ.
- ± 0.5 % E.M. typ.

AVANTAGES PRINCIPAUX

- ◆ Petits plages de pression (jusqu' à 100mbar)
- ◆ Température du fluide à 150°C
- ◆ Protection CEM , CEI 61000
- ◆ Optional: Protection de parafoudre (IEC 61000-4-5); 10kA (8/20 µs)

MAIN CHARACTERISTICS

- ◆ Sensor: Piezoresistive
- ◆ Measuring range: 0...0.1 to 0...1000 bar
- ◆ Signal output: 4...20 mA
- 4...20 mA with lightning
- protection (Surge)
- 0...10 VDC
- ◆ NLH (BSL through 0): ± 0.1 % FS typ.
- ± 0.25 % FS typ.
- ± 0.5 % FS typ.

MAIN FEATURES

- ◆ Low pressure ranges (to 100 mbar)
- ◆ Media temperature to 150°C
- ◆ EMC Protection, IEC 61000
- ◆ Option: Lightning protection (IEC 61000-4-5); 10kA (8/20 µs)



baugleiche Modelle mit anderen Spezifikationen:
version même construction avec d'autres spécifications:
identical construction with other specifications:

DATA SHEET NO: **H72227, H72232**
www.trafag.com/data-sheet

BESTELLINFORMATION / INFORMATION POUR LA COMMANDE / ORDERING INFORMATION

Lager Code (kurze Lieferzeit)/ Numéro de stock (délai de livraison bref)/ Code for stock products (short delivery time): **NAP** (z.B./ Ex./ e.g: NAP0.1A)

 siehe Katalog/ voir catalogue/ see catalogue: „Standard Products“

Varianten Code/ Codification de variantes/ Custom build code

Relativ/ Relatif/ Relative

Absolut/ Absolue/ Absolute

XXXX.XX.XX.XX.XX.XX.XX.XX...

8842

8843

| | | | | | | |
|---|------------|------------------------------|------|-----------------------------|------|-----------|
| Bereich | 0 ... 0.1 | Überdruck max. | 3 | Berstdruck max. | 200 | 66 |
| Plage | 0 ... 0.16 | Surcharge surpression | 3 | Pression destruction | 200 | 67 |
| Range | 0 ... 0.2 | Over pressure | 3 | Burst pressure | 200 | 68 |
| | 0 ... 0.4 | | 3 | | 200 | 69 |
| [bar] | 0 ... 0.6 | [bar] | 3 | [bar] | 200 | 70 |
| | 0 ... 1.0 | | 3 | | 200 | 71 |
| | 0 ... 1.6 | | 4.8 | | 200 | 73 |
| | 0 ... 2.5 | | 7.5 | | 200 | 75 |
| | 0 ... 4.0 | | 12 | | 200 | 76 |
| | 0 ... 6.0 | | 18 | | 200 | 77 |
| | 0 ... 10 | | 30 | | 200 | 78 |
| | 0 ... 16 | | 48 | | 200 | 79 |
| | 0 ... 25 | | 75 | | 200 | 80 |
| | 0 ... 40 | | 120 | | 850 | 81 |
| | 0 ... 60 | | 180 | | 850 | 82 |
| | 0 ... 100 | | 300 | | 850 | 83 |
| | 0 ... 160 | | 480 | | 850 | 85 |
| | 0 ... 250 | | 750 | | 850 | 74 |
| | 0 ... 400 | | 850 | | 850 | 84 |
| | 0 ... 600 | | 850 | | 850 | 86 |
| | 0 ... 1000 | | 1500 | | 1500 | 88 |
| Sonderbereich nach Kundenwunsch, z.B.: Plage à spécifier par le client, p. ex.: Customized ranges on request, e.g.: | | | | | | XX |
| -1... +4 bar, 0...5 bar, 0...12 bar | | | | | | XX |

| | | | |
|---|--------|---|-----------|
| Sensor | Typ 05 | (Genauigkeit NLH/ Précision NLH/ Accuracy NLH: ± 0.5 % FS) | P5 |
| Capteur | Typ 02 | (Genauigkeit NLH/ Précision NLH/ Accuracy NLH: ± 0.25 % FS) | P2 |
| Sensor | Typ 01 | (Genauigkeit NLH/ Précision NLH/ Accuracy NLH: ± 0.1 % FS) | P1 |
| Genauigkeit NLH / Précision NLH/ Accuracy NLH: siehe Tabelle/ voir table/ see table | | | |

| | | | |
|----------------------------|--------|---|-----------|
| Druckanschluss | G 1/4" | innen/ femelle/ female | 10 |
| Raccord | G 1/4" | aussen/ mâle/ male | 15 |
| Pressure connection | G 1/4" | aussen/ mâle/ male DIN16288 (Manometer/ manomètre/ manometer) | 20 |
| | G 1/2" | aussen/ mâle/ male | 21 |
| | G 1/2" | aussen/ mâle/ male Membrane: vorne liegend/ frontal/ frontal | 31 |
| | G 1/2" | aussen/ mâle/ male Membrane: frontbündig/ en face/ flush | 32 |
| | G 1/2" | aussen/ mâle/ male DIN16288 (Manometer/ manomètre/ manometer) | 11 |

| | | | | |
|-------------------|--|-------------------------------------|--------|-----------|
| Ausführung | PUR Kabel/ Câble PUR/ PUR Cable: | Länge/ Longueur / Length [mm] | (IP67) | 22 |
| Exécution | Gerätestecker/ Embase mâle/ Male electrical plug | DIN43650 A (Mat.: PA) | (IP65) | 04 |
| Execution | | Binder 723 (Mat.: Zn) | (IP67) | 14 |
| | | MIL-C 26482 (Mat.: Al) | (IP40) | 02 |

| | | |
|-------------------------|---|-----------|
| Ausgangssignal | 4...20mA | 19 |
| Signal de sortie | 4...20mA mit Blitzschutz/ avec protection de parafoudre / with lightning protection (Surge) | 09 |
| Output | 0...10V DC | 17 |

| | | | |
|--------------------|---|---------------------|-----------|
| Zubehör | Kabeldose/ Fiche femelle/ Female electrical connector | DIN43650 A | 58 |
| Accessoires | | Binder 723 | 37 |
| Accessories | | MIL-C-26485, 6-pol. | 32 |
| | Spez. Ölfüllung/ Remplissage d'huile special/ Special oil filling | Aseol | 94 |
| | | Halocarbon | 95 |
| | 8842: Elektronik vergossen/ 8842: électronique scellée/ 8842: electronics packed in gel | | 96 |
| | PUR Kabel/ Câble PUR/ PUR cable: IP67 | | 48 |
| | Betriebstemperatur/ Température de service/ Operating temperature -25...85°C | | 69 |
| | (Medientemp./ Temp. du fluide/ Media temp. -25...100°C) | | |
| | Betriebstemperatur/ Température de service/ Operating temperature -25...85°C | | 70 |
| | (Medientemp./ Temp. du fluide/ Media temp. -25...150°C) | | |

Dämpfungselemente und Snubber/ Élément d'amortissement à pointe de surpression et Snubber/ Damping elements and Snubber:
siehe Datenblatt/ voir spécification /see specification sheet H72258



Trafag entwickelt und produziert auch speziell auf Ihre Bedürfnisse zugeschnittene Produkte. Bitte fragen Sie uns an.
Trafag développe et fabrique des produits adaptés à vos besoins spécifiques en se basant sur votre cahier des charges. Contactez-nous s.v.p.
Trafag develops and manufactures customer-engineered products according to your specifications to meet your requirements. Please contact us.

ÄNDERUNGEN VORBEHALTEN - SOUS RÉSERVE DE MODIFICATIONS - SUBJECT TO CHANGE

SPEZIFIKATIONEN

SPÉCIFICATIONS

SPECIFICATIONS

HAUPTMERKMALE

Sensor: Piezoresistiv
Messbereich: 0...0.1 bis 0...1000 bar
Ausgangssignal: 4...20 mA
0...10 VDC

CARACTÈRES DISTINCTIFS

Capteur: Piézorésistif
Plage de mesure: 0...0.1 à 0...1000 bar
Signal de sortie: 4...20 mA
0...10 VDC

MAIN CHARACTERISTICS

Sensor: Piezoresistive
Measuring range: 0...0.1 to 0...1000 bar
Signal output: 4...20 mA
0...10 VDC

GENAUIGKEIT

PRÉCISION

ACCURACY

| Bereiche / Plage / Range | [bar] | 0.1...0.5 | 0.5...2 | 2...25 | 25...600 | >600 |
|--|-------------------|-----------|----------|-----------|-----------|-----------|
| Genauigkeit NLH ¹⁾ / Précision NLH ¹⁾ / Accuracy NLH ¹⁾ | [± % FS] | | | | | |
| | P5 | 0.5 | 0.5 | 0.5 | 0.5 | 0.5 |
| | P2 | 0.25 | 0.25 | 0.25 | 0.25 | 0.25 |
| | P1 | — | 0.1 | 0.1 | 0.1 | — |
| Temp.koeffizient/ Influence therm./ Temp. coefficient [± % FS/K] | | | | | | |
| Nullpunkt/ Point zéro/ Zero point | 0...70°C | 0.06 | 0.03 | 0.015 | 0.015 | 0.015 |
| | Option -25...85°C | 0.08 | 0.04 | 0.02 | 0.02 | 0.02 |
| Spanne/ Sensibilité/ Span | 0...70°C | 0.015 | 0.015 | 0.015 | 0.015 | 0.015 |
| | Option -25...85°C | 0.02 | 0.02 | 0.02 | 0.02 | 0.02 |
| Langzeitdrift/ Dérive en longue durée/ Long term drift [1 Jahr] | | < 4 mbar | < 4 mbar | < 0.2% FS | < 0.2% FS | < 0.2% FS |

¹⁾ BSL durch Null/ BSL par zéro/ BSL through zero

ELEKTRISCHE DATEN

Speisespannung
4...20mA: 9...33V DC
0...10V DC: 15...30V DC
Bürde
4...20 mA: $R_L \leq (U_s - 9V)/20mA$
0...10 VDC: $R_L > 10 K\Omega$
Reproduzierbarkeit: ±0.05 % d.S.
Anstiegszeit: typ. 1 ms/ 10...90%
Nenndruck

SPÉCIFICATIONS ÉLECTRIQUES

Tension d'alimentation
4...20mA: 9...33V DC
0...10V DC: 15...30V DC
Charge
4...20mA: $R_L \leq (U_s - 9V)/20mA$
0...10V DC: $R_L > 10 K\Omega$
Reproductibilité: ±0.05% E.M.
Sensibilité de réponse: 1 ms/10...90% typ.
pression nominale

ELECTRICAL DATA

Supply voltage
4...20mA: 9...33V DC
0...10V DC: 15...30V DC VDC
Load:
4...20mA: $R_L \leq (U_s - 9V)/20mA$
0...10V DC: $R_L > 10 K\Omega$
Repeatability: ±0.05% FS
Rise time: typ. 1 ms/10...90%
nominal pressure

UMGEBUNGSBEDINGUNGEN

Betriebstemperatur: 0...+70°C
(opt. -25...+85°C)
Medientemperatur 0...+80°C
(opt. -25...+100°C/ -25...+150°C)
Schutzart: ²⁾ min. IP65
Feuchtigkeit: max. 95% relativ
Vibration: 6g (25...2000 Hz)
Stoß: 50g/ 1 ms

CONDITIONS D'ENVIRONNEMENT

Température de service: 0...+70°C
(opt. -25...+85°C)
Température de médias: 0...+80°C
(opt. -25...+100°C/ -25...+150°C)
Protection: ²⁾ min. IP65
Humidité: 95% max. relatif
Vibration: 6g (25...2000 Hz)
Choc: 50g/ 1 ms

ENVIRONMENTAL CONDITIONS

Operating temperature: 0...+70°C
(opt. -25...+85°C)
Media temperature: 0...+80°C
(opt. -25...+100°C/ -25...+150°C)
Protection: ²⁾ min. IP65
Humidity: max. 95% relative
Vibration: 6g (25...2000 Hz)
Shock: 50g/ 1 ms

EMV-SCHUTZ

Emission: IEC 61000-6-3
Immunität: IEC 61000-6-2

CEM PROTECTION

Emission: CEI 61000-6-3
Immunité: CEI 61000-6-2

EMC PROTECTION

Emission: IEC 61000-6-3
Immunity: IEC 61000-6-2

MECHANISCHE DATEN

Material
Sensor: 1.4435 (AISI316L)
Gehäuse: 1.4435 (AISI316L)
O-Ring (medienberührend): FKM 70°Sh
Gerätestecker: siehe Bestellinformationen
Anziehdrehmoment: 25 Nm
Gewicht: ~ 220 g

SPÉCIFICATIONS MÉCANIQUES

Matière
Capteur: 1.4435 (AISI316L)
Boîtier: 1.4435 (AISI316L)
O-Ring (contact. de médias): FKM 70°Sh
Embase mâle: voir information pour la commande
Couple de serrage: 25 Nm
Poids: ~ 220 g

MECHANICAL DATA

Material
Sensor: 1.4435 (AISI316L)
Housing: 1.4435 (AISI316L)
O-Ring (media contacting): FKM 70°Sh
Male electrical plug: see ordering information
Mounting torque: 25 Nm
Weight: ~ 220 g

²⁾ nur mit vorschriftsmässig montierter Kabeldose gültig/ valable seulement avec fiche femelle montée selon instructions/ provided female connector is mounted according to instructions

MASSBILDER & EL. ANSCHLUSS / COTES D'ENCOMBREMENT & RACCORDEM. ELECTR. / DIMENSIONS & EL. CONNECTION

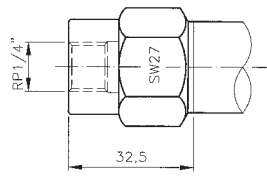

884X.XX.XX.10.XX.XX.XX...

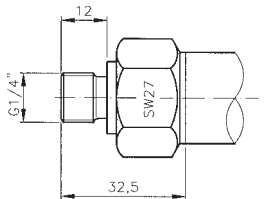

884X.XX.XX.15.XX.XX.XX...

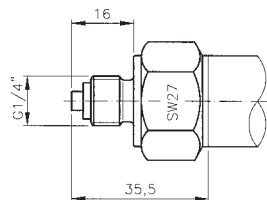

884X.XX.XX.20.XX.XX.XX...

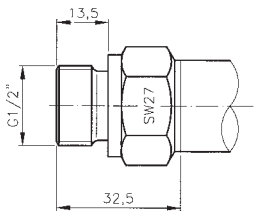

884X.XX.XX.21.XX.XX.XX...

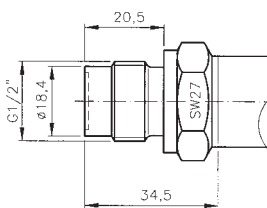

884X.XX.XX.31.XX.XX.XX...

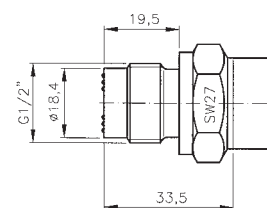

884X.XX.XX.32.XX.XX.XX...

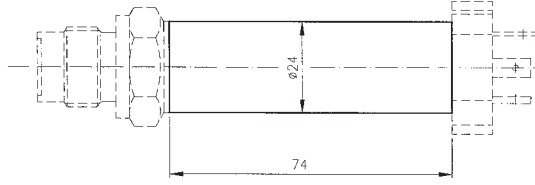

884X.XX.XX.XX.XX.XX.XX...
884X.XX.XX.XX.XX.XX.69...

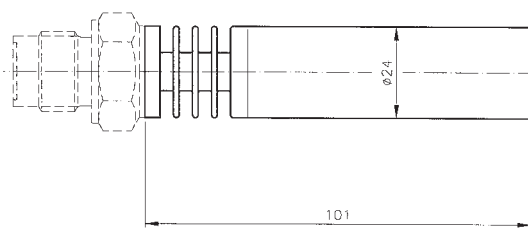

884X.XX.XX.XX.XX.XX.70...

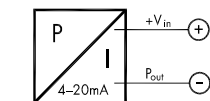

4...20 mA

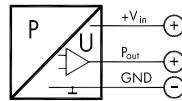

0...10 V DC

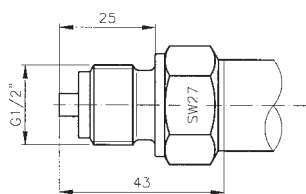

884X.XX.XX.11.XX.XX.XX...

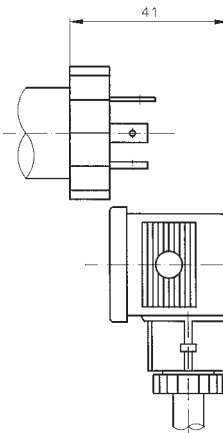

| Pin | 4...20mA | 0...10VDC |
|-----|----------|-----------|
| 1 | +Vin | +Vin |
| 2 | Pout | Pout |
| 3 | | GND |

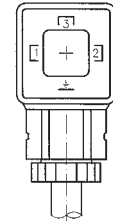

884X.XX.XX.XX.04.XX.58...

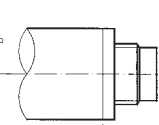

| Pin | 4...20mA | 0...10VDC |
|-----|----------|-----------|
| 1 | Pout | Pout |
| 3 | +Vin | +Vin |
| 4 | | GND |

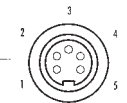

884X.XX.XX.XX.14.XX.37...

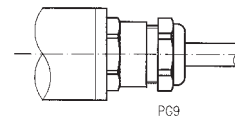

| Farbe/ Couleur/ Color | 4...20mA | 0...10VDC |
|-----------------------|----------|-----------|
| weiss/ blanc/ white | +Vin | +Vin |
| gelb/ jaune/ yellow | Pout | GND |
| braun/ brun/ brown | | Pout |

884X.XX.XX.XX.22.XX.XX...

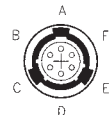
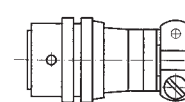

| Pin | 4...20mA | 0...10VDC |
|-----|----------|-----------|
| A | +Vin | +Vin |
| B | | GND |
| C | Pout | Pout |

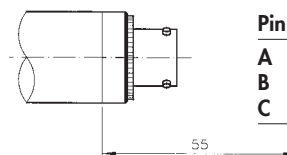

884X.XX.XX.XX.02.XX.32...