



**HAUPTMERKMALE**

◆ Schutzrohr: für Gase  
◆ Anwendung: Thermostat

**CARACTÈRES DISTINCTIFS**

◆ Doigt de gant: pour gaz  
◆ Application: Thermostat

**MAIN CHARACTERISTICS**

◆ Measuring range: for gases  
◆ Application: Thermostat

**SCHUTZROHRE  
FÜR DIREKTE BEFESTIGUNG**

**DOIGT DE GANT  
POUR MONTAGE DIRECT**

**PROTECTION TUBES FOR  
DIRECT MOUNTING**

Klemm-Befestigung, seitlich  
Raccord pour vis, latérale  
Grubscrew lock, lateral

**12**

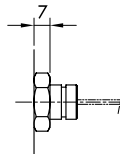

Befestigungsmutter mit Distanzierung (Kühlelement)  
Tube de refroidissement et raccord pour vis latérale  
Grubscrew locked with thermal distance piece

**18**

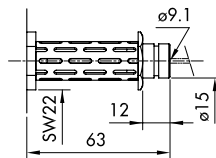

Material : Messing vernickelt  
Matière : Laiton nickelé  
Material : Brass nickel plated

für Typ/ pour type/ for type  
Alterostat 100 ...  
Industat 400 ... 419  
Ministat 600 ... 619  
Laborstat 753 ... 770

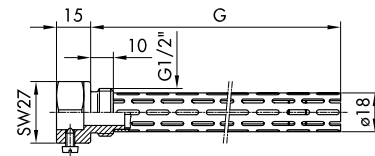

**1241  
1841**

Überwurfmutter  
Ecroû mobile  
Captive nut

**14**

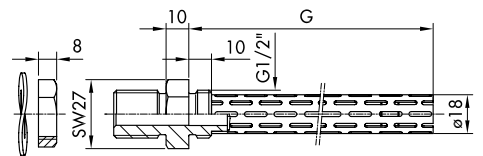
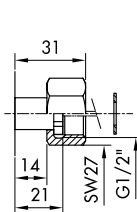

Material : Messing vernickelt  
Stahl 1.4435  
Matière : Laiton nickelé  
Acier inox 1.4435  
Material : Brass nickel plated  
Stainless steel 1.4435

für Typ/ pour type/ for type  
Ambistat 100 ...  
Industat 400 ... 419  
Ministat 624 ... 634  
Navistat 471, 472

**1441**

Konsole mit Befestigungsflansch, seitlich  
Console avec raccord pour vis, latérale  
Console with grubscrew locked, lateral

**21**

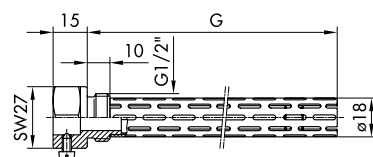
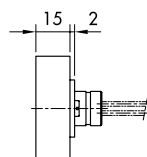

Material : Messing chem. vernickelt  
Matière : Laiton chim. nickelé  
Material : Brass chem. nickel plated

für Typ/ pour type/ for type  
Duostat300 ... 319

**2141**

**SCHUTZROHRE  
FÜR DIREKTE BEFESTIGUNG**

**DOIGT DE GANT  
POUR MONTAGE DIRECT**

**PROTECTION TUBES FOR  
DIRECT MOUNTING**

**Befestigungsbügel mit Schutzrohr  
Platine avec doigt de gant  
Mounting bracket with protection tube**

**27**

Material : Stahl vernickelt  
Matière : Acier nickelé  
Material : Steel nickel plated

für Typ/ pour type/ for type  
Industat 400 ... 419

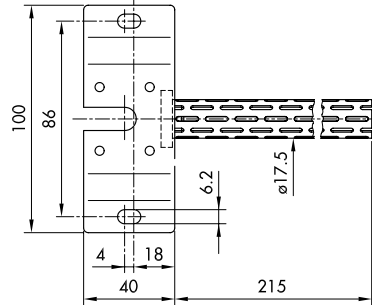
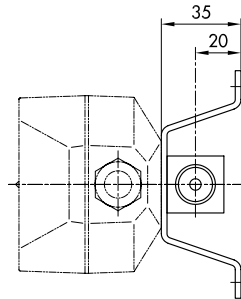

**2743**

**Distanz-Befestigung (Kühlelement)  
Refroidisseur  
Thermal distance piece**

**35**

Material : Messing vernickelt  
Matière : Laiton nickelé  
Material : Brass nickel plated

für Typ/ pour type/ for type  
Industat 400 ... 419  
Ministat 600 ... 619  
Laborstat 753 ... 770

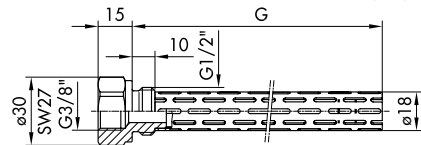
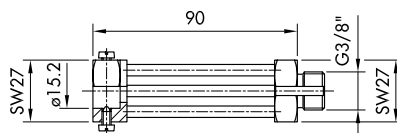

**8841**

Thermostat Befestigung Fixation pour thermostat Thermostat mounting	Schutzrohr Doigt de gant Protection tube	Länge Longueur Length	G [mm]	G [mm]	G [mm]	Material Matière Material
	<b>Code:</b>	615	415	275	215	
12	<b>1241</b>	5	5	5	5	Messing vernickelt Laiton nickelé Brass nickel plated
18	<b>1841</b>	5	5	5	5	
14	<b>1441</b>	9	5	5	5	
21	<b>2141</b>	5	5	5	5	
35	<b>8841</b>	9	5	5	5	
27	<b>2743</b> <b>2744</b>				5 5	Stahl vernickelt/ Acier nickelé/ Steel nickel plated Stahl verchromt/ Acier chromé/ Steel chrome plated

5 Lieferfrist 2 ca. Wochen  
Délai de livraison approx. 2 semaines  
Delivery time approx. 2 weeks

9 Auf Anfrage  
Sur demande  
On request

**SCHUTZROHRE FÜR FREI VERLEGTES  
KAPILLARROHR**

**DOIGT DE GANT POUR TUBE CAPIL-  
LAIRE À MONTER LIBRE**

**PROTECTION TUBES FOR  
REMOTE SENSOR**

Dichtend bis ca. 2 bar

Étanche jusqu'à approx. 2 bar

Gas tight upto approx. 2 bar

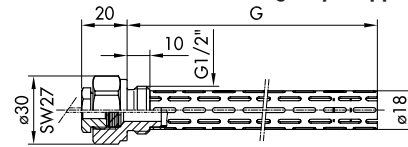
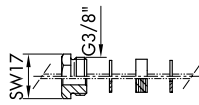

**8841**

siehe Zubehör/ voir accessoires/ see accessories

Dichtend bis 40 bar

Étanche jusqu'à approx. 40 bar

Gas tight upto approx. 40 bar

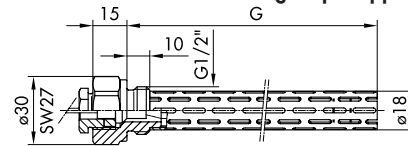
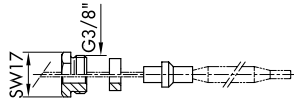

**7541**

siehe Zubehör/ voir accessoires/ see accessories

Schutzrohr Doigt de gant Protection tube	Länge Longueur Length	G [mm]	Material Matière Material
	425	275	215
<b>7541</b> <b>8841</b>	5	5	5
Messing vernickelt/ Laiton nickelé/ Brass nickel plated			









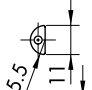
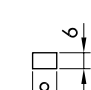
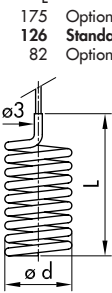
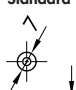

5 Lieferfrist ca. 2 Wochen  
Délai de livraison approx. 2 semaines  
Delivery time approx. 2 weeks



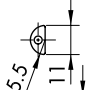

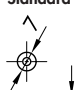
9 Auf Anfrage  
Sur demande  
On request



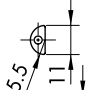
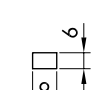
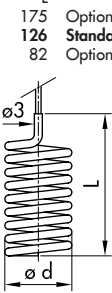

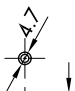
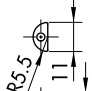
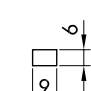
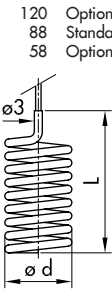
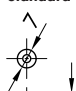
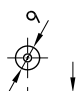
**FÜHLER**

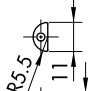
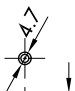
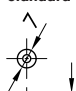
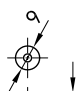
**SONDE**

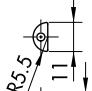
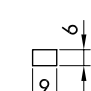
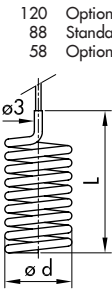
**SENSOR**

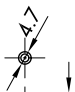
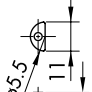
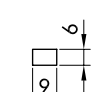
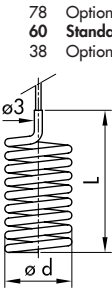
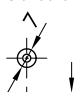
Bereich Plage Range		Standard							
									
°C -30 ... +40 -10 ... +25 0 ... 35 10 ... 45 10 ... 80 15 ... 30									
1.4435 (316 L) No.		<b>421</b>		<b>441</b>				<b>481</b> (nur d=35)	
Kupfer /Cuivre / Copper No.	<b>412</b>	<b>422</b>	<b>432</b>	<b>442</b>	<b>452</b>	<b>462</b>	<b>472</b>	<b>482</b>	
Kupfer vernickelt Cuivre nickelé Copper nickel plated No.	<b>413</b>	<b>423</b>	<b>433</b>	<b>443</b>	<b>453</b>	<b>463</b>	<b>473</b>	<b>483</b>	
Kupfer verchromt Cuivre chromé Copper chrom plated No.	<b>414</b>	<b>424</b>	<b>434</b>	<b>444</b>	<b>454</b>	<b>464</b>	<b>474</b>	<b>484</b>	

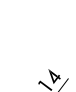
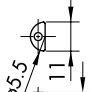
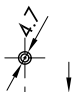
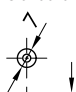
Bereich Plage Range		Standard							
									
°C -10 ... +35 -10 ... 80 5 ... 95 20 ... 110 20 ... 150									
1.4435 (316 L) No.		<b>311</b>	<b>321</b>	<b>331</b>	<b>341</b>			<b>381</b> (nur d=35)	
Kupfer /Cuivre / Copper No.	<b>312</b>	<b>322</b>	<b>332</b>	<b>342</b>	<b>352</b>	<b>362</b>	<b>372</b>	<b>382</b>	
Kupfer vernickelt Cuivre nickelé Copper nickel plated No.	<b>313</b>	<b>323</b>	<b>333</b>	<b>343</b>	<b>353</b>	<b>363</b>	<b>373</b>	<b>383</b>	
Kupfer verchromt Cuivre chromé Copper chrom plated No.	<b>314</b>	<b>324</b>	<b>334</b>	<b>344</b>	<b>354</b>	<b>364</b>	<b>374</b>	<b>384</b>	

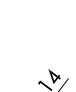
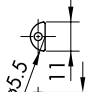
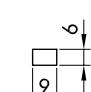
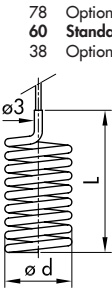
Bereich Plage Range		Standard							
									
°C 20 ... 230 40 ... 300 70 ... 350									
1.4435 (316 L) No.		<b>111</b>	<b>121</b>	<b>131</b>	<b>141</b>			<b>181</b> (nur d=35)	
Kupfer /Cuivre / Copper No.	<b>112</b>	<b>122</b>	<b>132</b>	<b>142</b>	<b>152</b>	<b>162</b>	<b>172</b>	<b>182</b>	
Kupfer vernickelt Cuivre nickelé Copper nickel plated No.	<b>113</b>	<b>123</b>	<b>133</b>	<b>143</b>	<b>153</b>	<b>163</b>	<b>173</b>	<b>183</b>	
Kupfer verchromt Cuivre chromé Copper chrom plated No.	<b>114</b>	<b>124</b>	<b>134</b>	<b>144</b>	<b>154</b>	<b>164</b>	<b>174</b>	<b>184</b>	

ÄNDERUNGEN VORBEHALTEN - SOUS RÉSERVE DE MODIFICATIONS - SUBJECT TO CHANGE

**ZUBEHÖR**

Für frei verlegtes Kapillarrohr

**Kapillarrohr-Verschraubung**

Auf dem Kapillarrohr verschiebbar, dichtend bis ca. 2 bar, mittels Metall- oder PTFE-Konus.

Anschlussgewinde: G1/8" aussen.

PTFE-Konus bis 280°C	Ms vernickelt	<b>60</b>
Metall-Konus bis 350°C	Ms vernickelt	<b>61</b>
PTFE-Konus bis 280°C	1.4435 (316 L)	<b>62</b>
Metall-Konus bis 350°C	1.4435 (316 L)	<b>63</b>

**ACCESSOIRES**

Pour tube capillaire à monter libre

**Raccord à vis pour tube capillaire**

Position ajustable sur tube capillaire, étanche jusqu'à 2 bar, avec cône métal ou PTFE. Filet du raccord: G1/8" mâle

Cône PTFE jusqu'à 280°C	laiton nickelé	<b>60</b>
Cône métal jusqu'à 350°C	laiton nickelé	<b>61</b>
Cône PTFE jusqu'à 280°C	1.4435 (316 L)	<b>62</b>
Cône métal jusqu'à 350°C	1.4435 (316 L)	<b>63</b>

**ACCESSORIES**

For remote sensor

**Capillary double camp nut assembly**

Adjustable position on capillary tube, tight upto 2 bar, sealing through metal or PTFE cone.

Connection thread: G1/8" male.

PTFE cone upto 280°C	Brass nickel plat.	<b>60</b>
Metal cone upto 350°C	Brass nickel plat.	<b>61</b>
PTFE cone upto 280°C	1.4435 (316 L)	<b>62</b>
Metal cone upto 350°C	1.4435 (316 L)	<b>63</b>

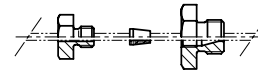
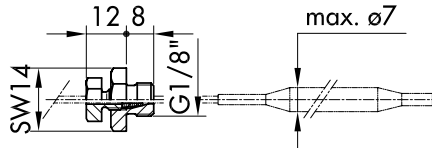

**Fühler-Doppelverschraubung**

Bis 40 bar dichtender Metallkonus am Fühler. Nicht verschiebbar. Nur für Fühler mit 4,7, 7 und 9 mm Durchmesser.

G1/4" aussen	Ms vernickelt	<b>65</b>
G1/4" aussen	1.4435 (316 L)	<b>66</b>
G3/8" aussen	Ms vernickelt	<b>68</b>
G3/8" aussen	1.4435 (316 L)	<b>69</b>
G3/8" aussen	Polyamid	<b>70</b>

**Raccord double pour sondes**

Étanche jusqu'à 40 bar avec cône métal au sonde. Pas ajustable. Seulement pour sondes avec diamètre 4,7, 7 et 9 mm.

G1/4" mâle	laiton nickelé	<b>65</b>
G1/4" mâle	1.4435 (316 L)	<b>66</b>
G3/8" mâle	laiton nickelé	<b>68</b>
G3/8" mâle	1.4435 (316 L)	<b>69</b>
G3/8" mâle	Polyamid	<b>70</b>

**Sensor double threaded coupling nut**

Tight upto 40 bar through metal cone on sensor. Not adjustable. Only for sensors with diameter 4,7, 7, and 9 mm.

G1/4" male	Brass nickel plat.	<b>65</b>
G1/4" male	1.4435 (316 L)	<b>66</b>
G3/8" male	Brass nickel plat.	<b>68</b>
G3/8" male	1.4435 (316 L)	<b>69</b>
G3/8" male	Polyamid	<b>70</b>

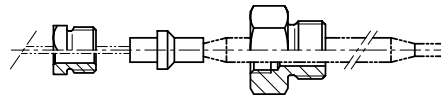
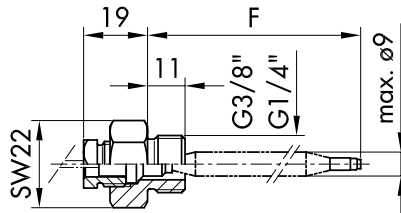

G1/2" aussen	Ms vernickelt	<b>71</b>
G1/2" aussen	1.4435 (316 L)	<b>72</b>

G1/2" mâle	laiton nickelé	<b>71</b>
G1/2" mâle	1.4435 (316 L)	<b>72</b>

G1/2" male	Brass nickel plat.	<b>71</b>
G1/2" male	1.4435 (316 L)	<b>72</b>

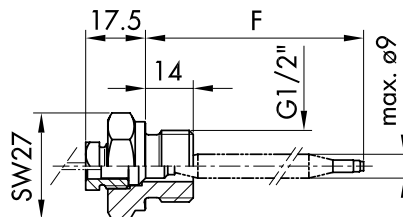

**ZUBEHÖR**

Für frei verlegtes Kapillarrohr

**Kapillarrohr-Durchführung**

Verschiebbare Verschraubung, dient zur Fixierung des Kapillarrohres. Gummi ölfest, bis ca. 2 bar dichtend. Maximale Temperatur 250°C (getemperter Silikongummi).

G3/8" aussen	Ms vernickelt	<b>80</b>
G3/8" aussen	1.4435 (316 L)	<b>81</b>

**ACCESSOIRES**

Pour tube capillaire à monter libre

**Traverséepour tube capillaire**

Raccord ajustable pour fixation de tube capillaire. Gomme (résistant contre huile), étanche jusqu'à approx. 2 bar. Température max. 250°C (gomme silicon vieillis).

G3/8" mâle	laiton nickelé	<b>80</b>
G3/8" mâle	1.4435 (316 L)	<b>81</b>

**ACCESSORIES**

For remote sensor

**Capillary locking nut assembly**

Adjustable clamping nut for fixation of capillary tube. Rubber oil-proof, tight upto approx. 2 bar, max. temperature 250°C (tempered silicon rubber).

G3/8" male	Brass nickel plat.	<b>80</b>
G3/8" male	1.4435 (316 L)	<b>81</b>

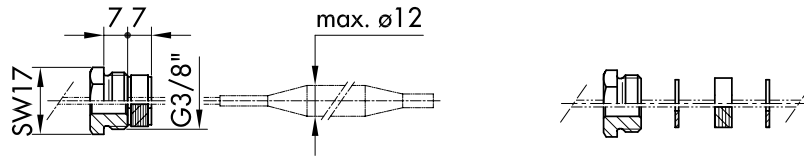

**Zubehör zum Schutz des Kapillarrohrs**

Metallschlauch	Ms vernickelt	<b>90</b>
Metallschlauch	1.4306 (304 L)	<b>91</b>

**Accessoires pour protection de tube capillaire**

Tuyau de métal	laiton nickelé	<b>90</b>
Tuyau de métal	1.4306 (304 L)	<b>91</b>

**Accessories for capillary tube protection**

flexible metal tube	Brass nickel plat.	<b>90</b>
flexible metal tube	1.4435 (316 L)	<b>91</b>

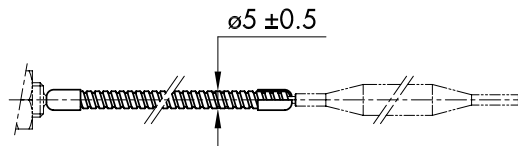

PVC-Schlauch bis 280°C

**92** Tuyau PVC jusqu'à 280°C

**92** PVC tube upto 280°C

**92**

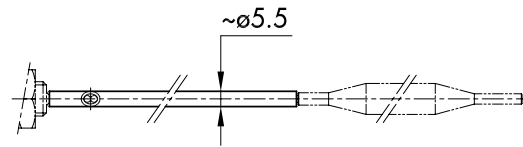
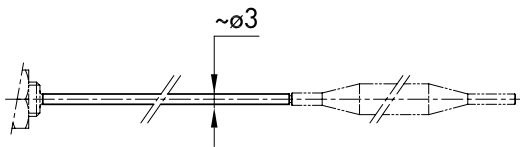

Duostat (2XX), Doppelthermostat (3XX)



Trafag entwickelt und produziert auch speziell auf Ihre Bedürfnisse zugeschnittene Produkte. Bitte fragen Sie uns an.  
Trafag développe et fabrique des produits adaptés à vos besoins spécifiques en se basant sur votre cahier des charges. Contactez-nous s.v.p.  
Trafag develops and manufactures customer-engineered products according to your specifications to meet your requirements. Please contact us.